

25ML DRENCHER/POUR-ON FAN SPRAY/T-BAR BACKLINER



The NJ Phillips 25ml Automatic is a quality precision instrument, designed for mass treatment of livestock with a variety of pharmaceutical solutions, drenchers and IGR pour-ons. Given normal care it will last indefinitely. As components in this instrument may be affected by solvents in some commonly used farm chemicals no responsibility will be accepted by the manufacturer should the instrument be used with such products.

BEFORE DRENCHING/POUR-ON

Always read the label: Check the label on the pharmaceutical manufacturer's container for dose rates, precautions, and safety information prior to use.

Use only the recommended dose rate: Use only the pharmaceutical manufacturer's recommended rates. Refer to the pharmaceutical manufacturer's dose rate chart or specification. NJ Phillips Pty Limited will take no responsibility if the instrument is used for any other purpose than specified or used contrary to the pharmaceutical manufacturer's dose rate specifications.

Check the instrument: Before each use, the nozzle should be inspected to ensure there are no sharp edges. Should this occur, remove with file or emery paper or replace nozzle.

THE MAIN FEATURES WHICH MAKE THIS INSTRUMENT SO PRACTICAL:

EASY ACCESS INTO INSTRUMENT



To access the internal parts of the instrument, it is important to hold the instrument as the return spring will force the handle and lever apart under pressure. Now simply remove the handle clip (2)

by sliding it out the groove in the handle. It is important to hold the instrument while doing this as the return spring will force the handle and lever apart under pressure. When the pushrod assembly comes free of the handle, access is then able to be made to the inlet valve spring assembly and to clean or replace the piston o-ring. When re-assembling, ensure the piston o-ring is lubricated with NJ Phillips Lubricant, then slide the pushrod assembly back into the handle, ensuring the return spring is located correctly in the handle and lever set. Then, secure the pushrod assembly by sliding the handle clip (2) back into the slot within the handle.

SUPERIOR VALVE DESIGN



INLET VALVE SPRING ASSEMBLY

The inlet valve (3) is housed in the front of the push rod and is accessed by removing the inlet valve spring assembly by holding the spring and turning in an anticlockwise direction to pull out of the front of the piston. To reassemble

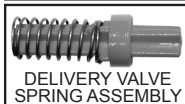

DELIVERY VALVE SPRING ASSEMBLY

once cleaned or being replaced, re-lubricate with NJ Phillips Lubricant, locate the inlet valve (3) of the assembly into the front of the piston and gently twist and push the valve spring assembly into the retaining clips.

The delivery valve is located at the rear of the needle mount. The delivery valve may be readily removed for cleaning.

TO SET DOSE FOR VARIABLE DOSE STYLE APPLICATOR

The dose can be set from 1.0ml to 25ml. The dose is very easily set. You simply turn the dose adjuster and align the front of the piston with the graduation shown on the barrel.

TO SET DOSE FOR DIAL-A-DOSE STYLE APPLICATOR



Ensure the handle and lever are in the fully open position before changing the dose. Do not squeeze to change the dose as this will damage the instrument.

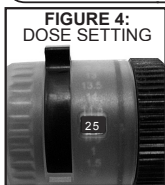

FIGURE 4: DOSE SETTING

The dose can be set from 0.5ml to 25ml. The dose is very easily set. You simply turn the dose adjuster so the required dose is shown in the dose window.

VISIBLE DOSE

Transparent graduated dose window provides instant check of dose.

INSTRUCTIONS FOR USE

1. Connect the handpiece to the container of material by means of the connecting tube and squeeze the lever several times to prime the instrument.



Care must be taken to ensure the liquid does not come into contact with any part of the operators body. Chemicals may cause injury to the operator.

2. Check dosage accuracy. It is a wise precaution to check the dose with each new container used. Use a measuring flask to test the dose.

DRENCHING

Ensure that all equipment is thoroughly clean before use, by flushing with water.

Before each use the nozzle should be inspected to ensure plating is not damaged or worn to a sharp edge. Should this occur, remove with file or emery paper or replace nozzle.



Always exercise care when dosing animals. Do not apply undue pressure and ensure the nozzle is not forced against or through delicate mouth and throat tissues.

After Drenching: Where suspension type drenches have been used it is advisable to flush the complete equipment with a water detergent mix. This should be followed by clean water. Solution type drenches normally require only a thorough flushing with clean water. All moving parts should be lubricated before storage.



POUR-ON

Refer to the chemical manufacturer's label and instructions for the correct application position and dose recommendations. The illustrations shown, indicates the preferred position of a 5 Litre upright draw-off system and 20 Litre container.

IMPORTANT DO NOT store your applicator or feed tube full of product. Clean as per the "After Drenching" instructions.

25ml Drencher: Suitable for Sheep/Goats

SPARE PARTS AVAILABLE (Please order by Kit No. & Part Name):

KIT No.	PART NAME	ILLUSTRATION No.
WX1610	Service Kit	1,3,4.
WX1629A	Feed Tube Adaptor Kit	Not Illustrated.

25ml Pour-On Fan Spray: Suitable for Sheep/Goats

SPARE PARTS AVAILABLE (Please order by Kit No. & Part Name):

KIT No.	PART NAME	ILLUSTRATION No.
WX1611	Service Kit	1,3,4.
WX1629A	Feed Tube Adaptor Kit	Not Illustrated.



25ml T-Bar Backliner: Suitable for Cattle/Sheep/Goats

SPARE PARTS AVAILABLE (Please order by Kit No. & Part Name):

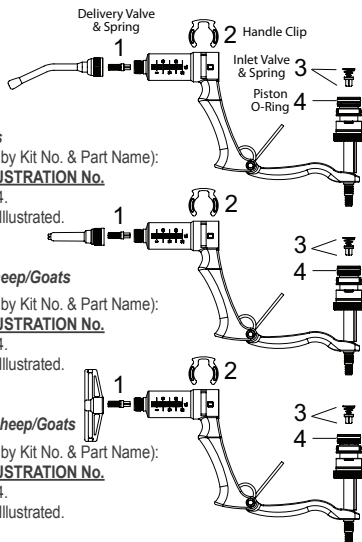
KIT No.	PART NAME	ILLUSTRATION No.
WX1611	Service Kit	1,3,4.
WX1612	T-Bar Backliner	Not Illustrated.
	Replacement Head Kit	
WX1629A	Feed Tube Adaptor Kit	Not Illustrated.

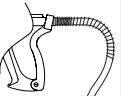

IMPORTANT: QUICK REFERENCE TROUBLESHOOTING GUIDE

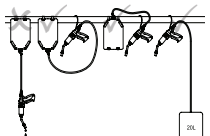
SYMPTOM	PROBABLE CAUSE	CORRECTIVE ACTION	
1. Unable to draw product from the container.	Kink in feed tube or blockage within the tube or draw-off system.		 Ensure feed tube spring is located correctly on instrument and draw-off.
2. Fluid dripping/running out of nozzle when not in use.	Instrument is hanging at end of feed tube when not in use.	 Hang instrument at same height or higher than off take point of feed tube on container of product. This ensures the delivery valve is free of load which can cause the product to leak past the valve assembly.	



njphillips.com

Our expertise is in your hands.

NJ PHILLIPS PTY LTD ABN 36 000 082 002

ADDRESS: LOCKED BAG 8, GOSFORD, NSW 2250 AUSTRALIA

TELEPHONE: +61 2 4340 2044 FAX: +61 2 4340 1991

EMAIL: njp1@njphillips.com.au MADE IN AUSTRALIA

AS OUR POLICY IS ONE OF CONTINUOUS IMPROVEMENT THE MANUFACTURER RESERVES THE RIGHT TO ALTER THESE SPECIFICATIONS AT ANY TIME. ALL PRODUCTS PRODUCED BY NJ PHILLIPS PTY LIMITED, ARE IDENTIFIED BY A UNIQUE BATCH NUMBER. THIS IDENTIFICATION NUMBER IS AFFIXED TO THE PRODUCT TO ALLOW TRACEABILITY BY THE MANUFACTURER AND MUST NOT BE REMOVED IF PRODUCT INTEGRITY IS TO BE MAINTAINED.

PAD778,PAM754,PAM1313,PAM1448,EAD1253,EAD1259 | QL702-R13